

Christchurch Botanic Gardens Concepts

Concept 1

- The new visitor and operational facilities are sited together at the existing Gardens works and nursery site.
- A new pedestrian and vehicle access bridge across the Avon River directly accesses this site.
- The new complex is integrated with Cunningham House.
- A new pedestrian bridge crosses the Avon River from the Daffodil Woodland area in Hagley Park to an arrival point between the Archery and Armstrong Lawns in the Gardens.

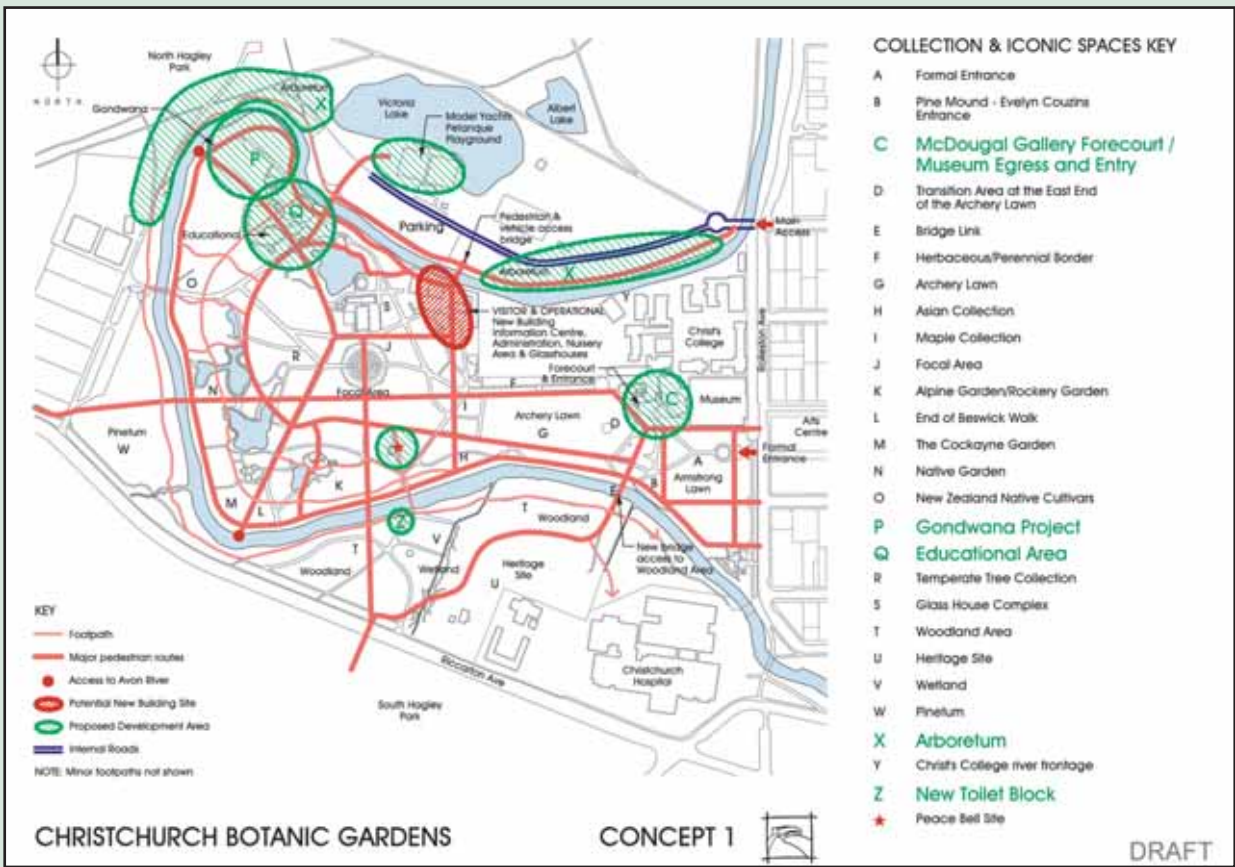

Concept 2

- The new visitor/information centre is located in Hagley Park between the Avon River and the western end of Victoria Lake.
- New operational facilities are sited together at the existing Gardens works and nursery site.
- A new vehicle access bridge crosses the Avon River to provide direct access to the operational site.
- A new pedestrian bridge crosses the Avon River from the Daffodil Woodland/hospital grounds area in Hagley Park, to the Armstrong Lawn in the Gardens.

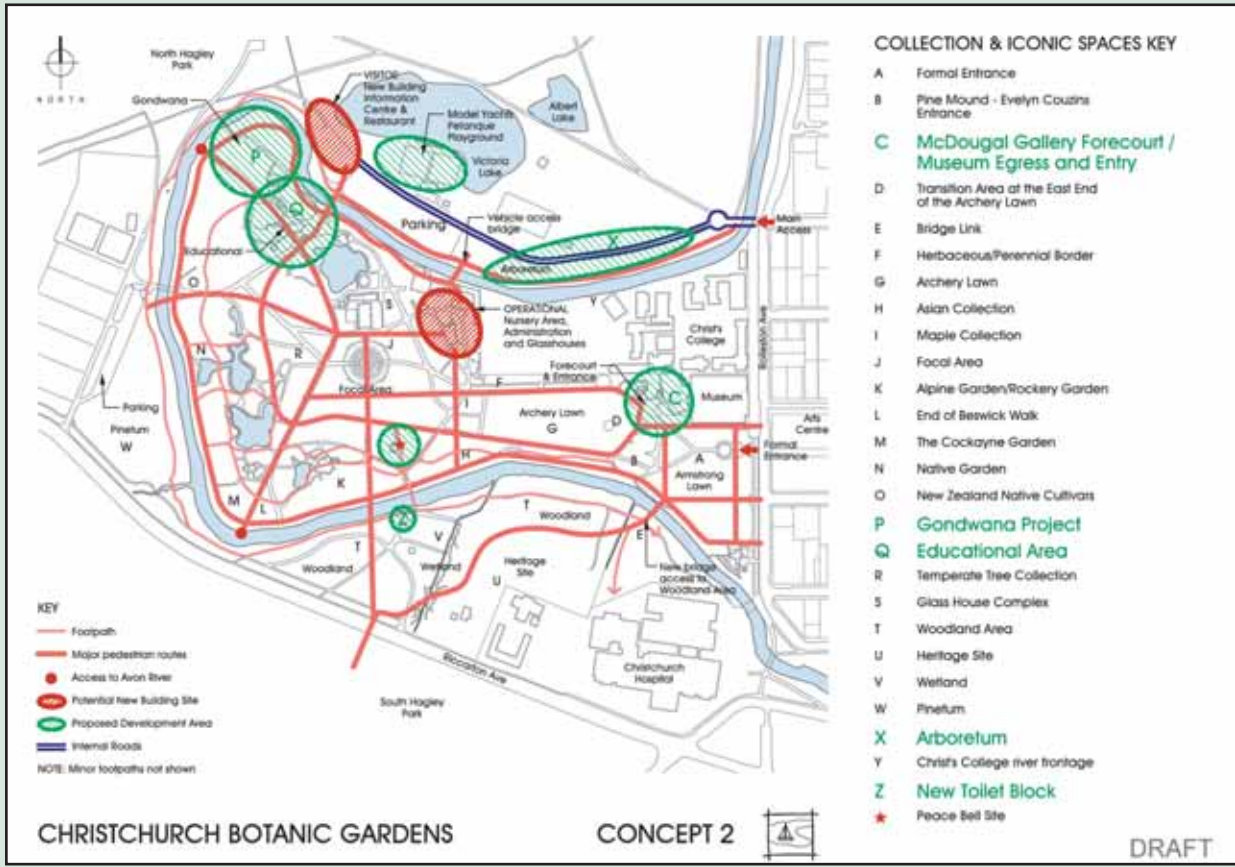

Concept 3

- The new visitor and operational facilities are sited in a complex including parking and a playground in the United Car Park, Hagley Park.
- A new pedestrian and vehicle access bridge crosses the Avon River in line with the new complex and a new route through the Gardens' native section to the conservatory/rose garden area.
- A new pedestrian bridge crosses the Avon River from the Daffodil Woodland area in Hagley Park to the area between the Archery and Armstrong Lawns in the Gardens.

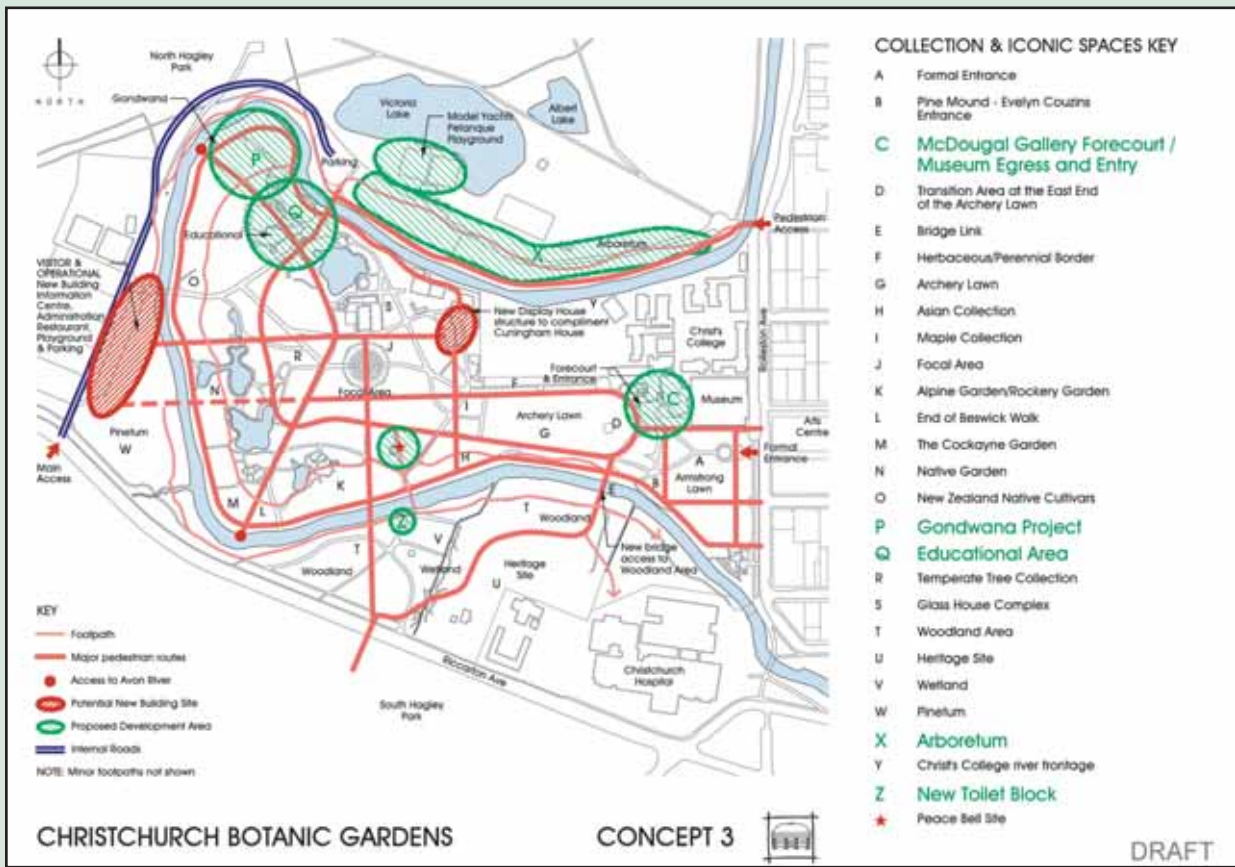

Hagley Park and the Christchurch Botanic Gardens

Planning for the future

A growing urban population, expanding tourism and development of the inner city puts increasing pressure on access to and the use of Hagley Park, the Botanic Gardens and surrounding areas. The Council has committed \$11.1 million for a new information centre and to upgrade operational facilities. To ensure these funds are spent wisely and that the Park and the Gardens can meet future demands without compromising their special features, the Council has been conducting a planning process.

In 2004 we invited the public to share their vision for these spaces. There was a diversity of viewpoints expressed on a number of issues such as car parking and the protection of the intrinsic values of the Park and the Gardens from inappropriate development. Overall, submitters indicated that they strongly value these places.

This feedback has been considered and incorporated in three draft plans which are now available for public feedback:

1. Draft Hagley Park / Botanic Gardens Master Plan

Hagley Park and the Botanic Gardens are inter-related so we have produced a new Hagley Park/ Botanic Gardens Master Plan that provides a vision and long-term direction for these two places. The plan includes the goals and objectives we want to achieve and proposes a number of projects. An indicative programme and budget for these projects is given for the next ten years.

2. Draft Hagley Park Management Plan

The statutory Hagley Park Management Plan was last reviewed in 1990. The Council have updated it to include an implementation plan to address a range of issues, such as the formalisation of sports club facilities on the Park and the replacement of aging trees.

3. Christchurch Botanic Gardens Management Plan

We have also updated the Christchurch Botanic Gardens Management Plan to include a new section on key issues affecting the Gardens and proposed actions to address them.

[www.ccc.govt.nz/haveyoursay](http://www.ccc.govt.nz/haveyoursay)



**Have Your Say**  
Community input into the plans will help ensure the Park and Gardens are well managed now and for future generations.  
Please fill in the submission form in this brochure and freepost back to us or make a submission online at [www.ccc.govt.nz/haveyoursay](http://www.ccc.govt.nz/haveyoursay)

Submissions close 5.00pm Wednesday 25 October 2006

Want further information?

- Read draft plans at any Council library or service centre
- Download the draft plans at [www.ccc.govt.nz/haveyoursay](http://www.ccc.govt.nz/haveyoursay)
- Request copies of the draft plans from 03 941 8999
- Attend a public meeting:
  - Monday 28 August, 12.15 – 1.45 pm, Christchurch Netball Centre, South Hagley Park
  - Thursday 31 August, 7.30 – 9 pm Christchurch Netball Centre, South Hagley Park.
- Contact Botanical Services Operations Team Manager, Jeremy Hawker, (03) 941 7580 or [jeremy.hawker@ccc.govt.nz](mailto:jeremy.hawker@ccc.govt.nz)



Hagley Park / Botanic Gardens Consultation  
Communication Team  
Christchurch City Council  
P O Box 237  
Christchurch



## HAGLEY PARK / CHRISTCHURCH BOTANIC GARDENS PLANS SUBMISSION FORM

We welcome your submissions on any of the draft plans and proposals. (Please attach sheets of paper if more space is required)

Name:

Address:

Telephone Number:

Email:

☐ Yes I wish to speak about my submission before a hearing panel.

**Submissions close 25 October 2006**

### Quick response to key proposed projects

Project 37. Where do you think the new visitor/information centre should be located?

- ☐ Concept 1      ☐ No preference  
☐ Concept 2      ☐ Other (please write below)  
☐ Concept 3

Project 38. Where do you think the Gardens operational facilities should be located?

- ☐ Concept 1      ☐ No preference  
☐ Concept 2      ☐ Other (please write below)  
☐ Concept 3

Project 6. What is your preferred circulation pattern for the Gardens?

- ☐ Concept 1      ☐ No preference  
☐ Concept 2      ☐ Other (please write below)  
☐ Concept 3

Project 13. Do you support slowing or reducing vehicle traffic on Riccarton Avenue?

- ☐ Yes      ☐ Option 1  
☐ No      ☐ Option 2  
            ☐ Other (please write below)

Project 17. Do you support less vehicle traffic on the section of Rolleston Avenue between Gloucester and Hereford Streets?

- ☐ Yes      ☐ No preference  
☐ No

Do you support the removal of parking on this section of Rolleston Avenue?

- ☐ Yes      ☐ No preference  
☐ No

Do you support the narrowing of the parking area on this section of Rolleston Avenue?

- ☐ Yes      ☐ No preference  
☐ No

19. Do you support the closure to vehicle traffic of the part of Helmores Lane that passes through Little Hagley Park and its reinstatement as park space?

- ☐ Yes      ☐ No preference  
☐ No



The Avon River flows between the Christchurch Botanic Gardens and Hagley Park

### Comments

This is a public submission and will be available for the public to view.



**Proposed Master Plan Projects August 2006**



CUT AND RETURN FREEPOST TO CHRISTCHURCH CITY COUNCIL

## PROPOSED PROJECTS FOR HAGLEY PARK AND THE CHRISTCHURCH BOTANIC GARDENS

No.	Name of Project (some projects are approved and others are just ideas)	What is being proposed? (for more information see Appendix 1 on the separate draft document)
1	Artworks in Hagley Park and the Gardens	Decide if a policy is needed to guide future placement of art works.
2	Environmental audit / implementation	Apply environmentally responsible practices for the use of energy, chemicals, other resources and waste disposal.
3	Events and exhibitions strategy	Adopt a more coherent and consistent approach to events and exhibitions.
4	Finance and income strategy	Guide commercial activity and ensure a range of sources of income are effectively utilised.
5	Heritage conservation plan	Formally recognise, interpret and conserve the heritage and cultural significance of the Park and Gardens.
6	Landscape, layout and circulation of the Park and the Gardens	The Garden pathways, entrances and bridges are ad hoc, confusing and fragmented. It is proposed to review and adjust the circulation, while conserving the special characteristics of the Gardens that people hold dear and protecting heritage values. The circulation pattern will depend upon the final location of the new Botanic Garden facilities.
7	Marketing strategy	Promote the Park and Gardens as top city centre attractions and decide which market to target.
8	Monitoring feedback on public use / satisfaction	Establish a system for regularly accessing who uses the Park and Gardens and how satisfied they are.
9	Tree replacement	Survey 6,500 trees and replace many old and diseased trees in a programmed way.
10	Water conservation	Adopt water conservation measures such as mulching and drop feeding. Use drought tolerant plants and lawns.
11	Wildlife and habitat conservation plan	Plan to encourage wildlife, especially native birds.
12	Blenheim Road deviation	New carparks on Deans Avenue and new pedestrian/cycle way to Blenheim Road.
13	Riccarton Avenue as a people-friendly 'park road'	Riccarton Avenue cuts Hagley Park in half and is difficult for pedestrians, cyclists and others to cross. To improve safety for people, provide more parking and link the two park halves, it is proposed to slow or reduce vehicles on the avenue. Options: 1. Halve road carriage way / reduce lanes to one each way. 2. Install traffic slowing features.
14	Landscape conservation	Create a landscape conservation zone around the Park so surrounding developments are sympathetic.
15	Park Terrace landscaping	A proposed redevelopment programme to protect / strengthen Park Terrace / Avon River bank character.
16	Road adjustments	Possible improvements to the road network around the Park.
17	Rolleston Avenue enhancement	Rolleston Avenue is a major crossing point for people moving between the Gardens / Museum / the College and Worcester Boulevard/ Arts Centre. To make it more accessible, safe and attractive, it is proposed to shift the focus of Rolleston Avenue between Gloucester/ Hereford Streets from vehicle traffic to people. Options: 1. Downgrade the vehicle traffic role like on Worcester Boulevard. 2. Remove some parking spaces. 3. Make parking spaces smaller (shorter and/or narrower)
18	Park building removal	Consider options for unused / unnecessary buildings, including removal.
19	Turn the section of Helmores Lane in Little Hagley Park into Park space	Benefits in closing Helmores Lane between the Avon River and Harper Avenue: • Enhancing the area available as people-friendly public recreational open space. • Improved tree health with removal of sealed road surface / no impact on tree roots. • Better protection for the heritage bridge. • Not impact on traffic flow and safety. Options: 1. Initiate the required statutory process to close this section of road (not a legal road) and reinstate it as Hagley Park green open space (provided for in existing legislation). 2. No change – ensure vehicles confined to road.
20	Armagh Street entrance improvements	Redesign entrance so it is more effective and attractive, but do not shift the gates.
21	Extension of model yacht club building	Grant new lease to club for building extension for toilets.
22	Ex-North Hagley Bowls Club facilities	Decide what to do with the building, which is costly to bring up to the public building standard.
23	House – 4 Riccarton Avenue	Decide what to do with the underused building, which is in poor condition and costly to restore to the public building standard.
24	Land exchange for Nurses' Memorial Hospital Chapel reserve	Formalise occupation of Hagley Park for hospital car parking and protect land under chapel and a land exchange with the health board.
25	Raise pathway – North Hagley Park	Install raised pathway between Albert Lake and the special events area for major event facilities, eg. a big screen.
26	Potential land exchange with health board	Exchange land in Hagley Park for the hospital riverside grounds.
27	Proposed golf course extension	Golf club application to extend its course into the Carlton Mill sports ground area of North Hagley Park.
28	Rugby club use of building	High School Old Boys' Rugby Club request to use / develop Park toilet / shower block for storage.
29	Alternative use of the netball courts	Investigate other uses for the netball centre if the Netball Association departs
30	Canterbury Horticulture Society (CHS) parking	Investigate shifting access to overflow parking area behind CHS building.
31	Hagley Oval fence	Crickets Association application to erect high wooden fence around Hagley Oval for pay-to-view cricket events.
32	Proposed artificial hockey pitch	Christ's College application for artificial hockey pitch in South Hagley Park polo grounds.
33	Sewer line – South Hagley Park	New sewer line (Western Interceptor) proposed across South Hagley Park.
34	Shift of HSOB rugby club rooms to Hagley Oval	Enquiry by High School Old Boys (HSOB) Rugby Club to relocate its clubroom in Hagley Oval Cricket Pavilion.
35	South Hagley Park multipurpose stormwater treatment / water concept	Develop a pond in the woodland behind the netball centre for combined stormwater treatment and ecological / landscape purposes.
36	Waterway enhancement	Enhance the landscape and natural values of the Avon River tributaries (Riccarton Stream and Addington Brook).
37	New visitor / information centre for the Botanic Gardens	The existing information centre in the Gardens does not meet existing and future visitor needs. It is proposed to build a new visitor / information centre for both the Gardens and the Park, which could be located in the Park.
38	New operational facilities for the Botanic Gardens (including staff offices and works yard)	The staff and other operational facilities in the Botanic Gardens are old, outdated and inadequate. It is proposed to replace these with new facilities, which could be integrated with the proposed new visitor / information centre. The Council has allocated \$11.1 million to replace the Gardens information centre and upgrade staff facilities. Three options have been developed (see back page).
39	Botanic Gardens biosecurity policy	Develop policy for surveillance / control of pests and to ensure nuisance plants are not spread.
40	Children's garden	Create a garden where children can connect with the plant world.
41	Collection revitalisation for the Botanic Gardens	Propagate, replant and consolidate plant collections.
42	Development of collections database	Introduce new 'designed-for-the-purpose' computer software to integrate information about plant collections.
43	Education programme enhancement	Expand education about relationships with plants / conservation.
44	Gondwana Garden	Create a new garden that demonstrates the evolution of Southern Hemisphere flora.
45	New collections for the Botanic Gardens	Establish new collections, especially to profile Canterbury native plants and threatened plants.
46	New conservatory complex	Consider building a new complex of interconnected conservatories in the Botanic Gardens.
47	Peace bell installation, Botanic Gardens	To be installed north of the Woodland Bridge in Oct 2006 as part of a new city Peace Walk.
48	Redevelop Botanic Gardens / Museum interface	Enhance the surrounds of the Robert McDougall building with botanical plantings.
49	Re-house the bonsai collection	Re-house the bonsai tree collection in the new Botanic Gardens facilities.
50	Restoration / conservation of the Magnetic Outside Workshop	Restore the magnetic hut, which was used by Captain Robert Scott en route to Antarctica.
51	Restore Cockayne Garden / redevelop New Zealand section	Reorganise and replant the Cockayne Garden to be an adequate memorial to one of New Zealand's most eminent biologists.
52	Retailing, information centre and catering needs	Relocate, consolidate and integrate retail, information and catering facilities in the Gardens.
53	Review of governance and audit processes	Formalise the way the Council seeks external expert advice on the direction and operation of the Gardens.
54	Satellite gardens ('extended botanical garden')	Enrich the botanical content of some of the city's other parks.
55	Science and research facility / programme	Develop Garden's research role by expanding library / herbarium, develop seed bank and have facilities for researchers.
56	Fencing of helipad for the emergency transfer of patients to Christchurch hospital	Application by helicopter operator to erect fencing for public safety as an interim measure until the development of a helipad in the hospital grounds.

Visit [www.ccc.govt.nz/haveyoursay](http://www.ccc.govt.nz/haveyoursay) to see the full plans.